

Querschnitt

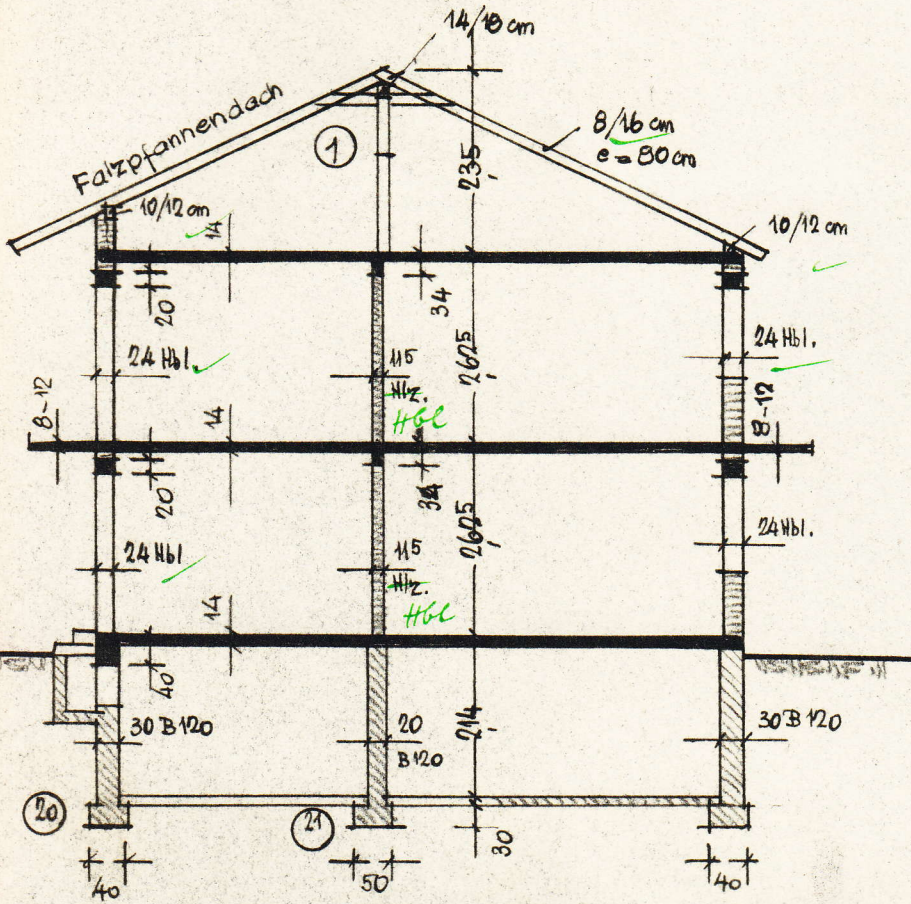

Beton Stahl: **II** Beton Güte: **B 225**
 Korntrennung: 0-7 mm; 7-30 mm
 Zementart nach DIN 1164
 Zementmenge: **270 kg/m³ Fertigtebeton**

Datum 29. Nov. 1954	Bauingenieur Heinrich Büttner München 13 Böttingerstraße 13 Fernruf 33881	Zeichnung 541 07/1
Maßstab 1:100	<i>H/B</i>	Ersatz

Reihenhaussiedlung Typ C (*dunkelgrün*)
 in München an der Murnauerstraße
 für die Südhausbau GmbH. München

Konstruktions Übersichtsplan.



Obergeschoß

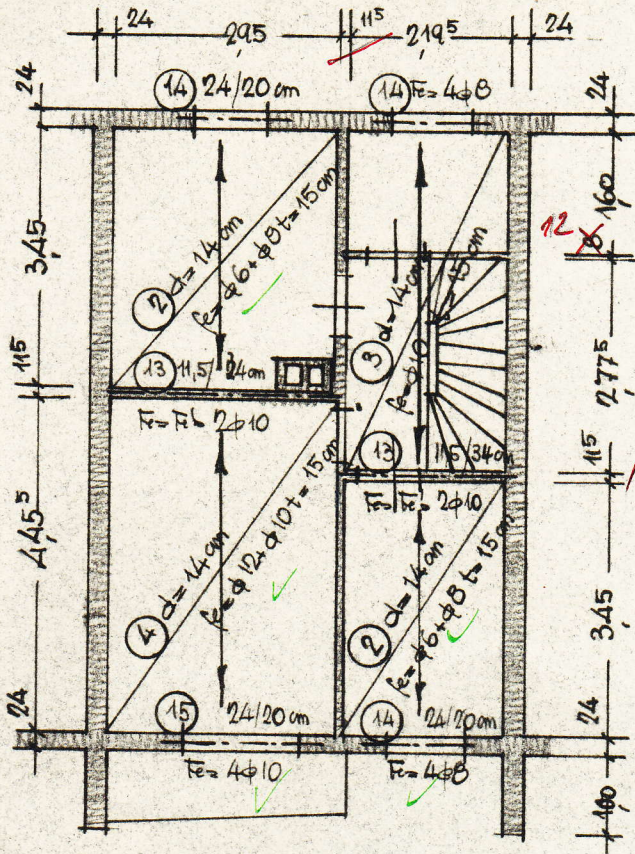

Erdgeschoß

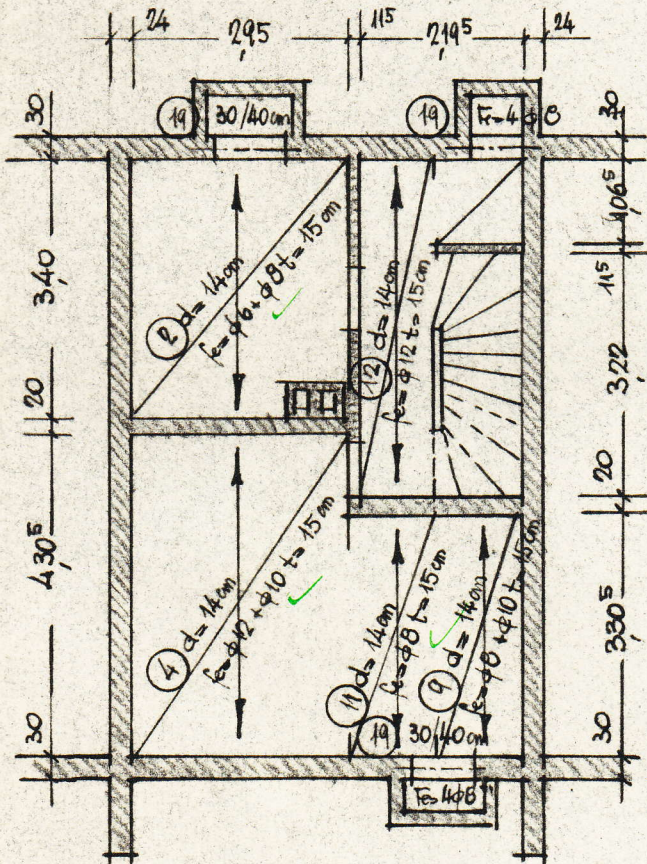
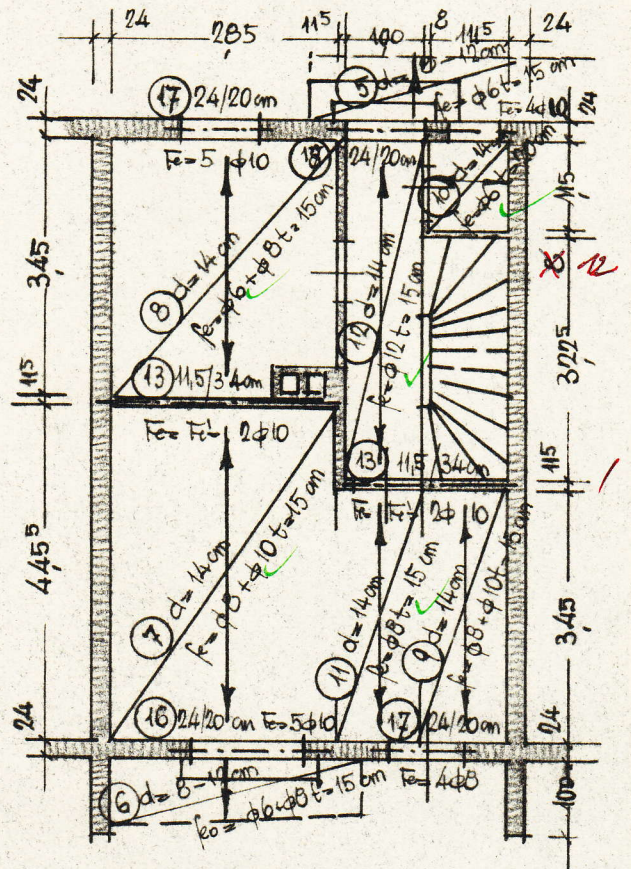

Kellergeschoß

in statischer Hinsicht geprüft











München, den 28. Jan. 1955

STADT. PROFAMT. FÜR BAUSTATIK

Handwritten signature

In statischer Hinsicht geprüft
München, den 20.1.1955
Prof. Profant + Baustatik
i.H. (geg.) Klose

Zeichenerklärung:

-  Hbl Hohlblocksteine
-  Hlz Hochlochziegel
-  Mz 150 Mauerziegel
-  HHS 250 Hüttenhartsteine
-  KMz 350 Klinkermauerziegel
-  KZM Desgl. in Kalkzementmörtel = Mörtelgruppe II
-  ZM Desgl. in Zementmörtel = Mörtelgruppe III
-  Stahlbeton
-  Stampfbeton
-  Leichtsteinmauern
-  alte, vorhandene Mauern